

Page



Powertec Wireless Technology  
ABN: 42 082 948 463  
PO Box 1034, Ashmore City  
Queensland, Australia, 4214  
sales@powertec.com.au  
1300 769 378

## **Surefoot S600 Pile Cap - 16 Piles (piles not included)**

SKU  
MAS-BH-00083  
MPN  
S600

**Description**

Surefoot's largest model is designed to take higher loads and is used mainly in the commercial and renewable energy sector. The recommended maximum capacity is 300 kN. It has an average installation time of 40 minutes.

The S600 – 16 pile model can be used on its own or in combination to negate higher bending moment loads.

Bolting Pattern:

350-400 PCD x 4 x 26mm holes

432-500 PCD x 4 x 32mm holes

Required Micro Piles:

16 x 32NB (Nominal Bore) 42.4OD

Galvanised Pile Light, Medium, Heavy

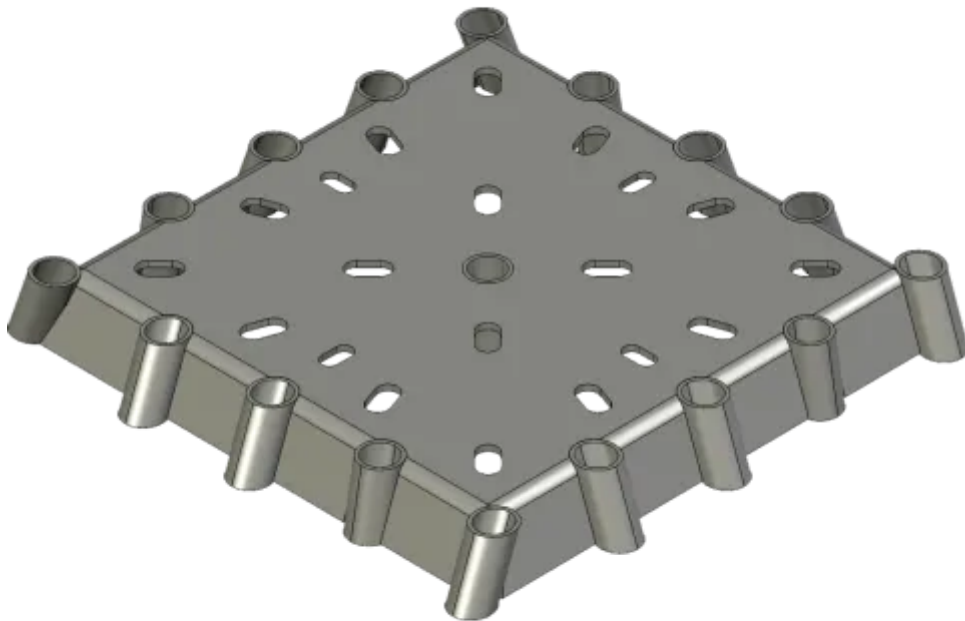



## Surefoot Footings

Surefoot Footings is a company based in Melbourne, Australia specialising in the manufacture of concreteless footings.

Surefoot is an “all in one system”, where the unique shape and high strength steel combines to create a very efficient pile cap. Once piles are driven and the cap secured, the opposing forces of the multi directional piles provides a solid, stable and economical footing. The system ...

## Physical Specification

Dimensions

708 × 708 × 70 mm

Installation Surfaces

Ground-Mounted

Weight

40.64 kg

## Subcomponents

Quantity	Name	Materials	Material Finish
1	S600 Assembly, Fully Welded	<a href="#">Steel</a>	<a href="#">Hot-Dip Galvanised</a>

## Available Interfaces

Quantity	Mounting
1	S600 Bolt Pattern

# Installation Interface

Quantity	Mounting	Details
16	32NB / 42OD Pile Multiple Pile Lengths Supported	

Disclaimer: Although care has been taken to ensure the accuracy, completeness and reliability of the information provided, Powertec assumes no responsibility therefore. The user of the information agrees that the information is subject to change without notice. Powertec assumes no responsibility for the consequences of use of such information, nor for any infringement of third party intellectual property rights which may result from its use. IN NO EVENT SHALL POWERTEC BE LIABLE FOR ANY DIRECT, INDIRECT, SPECIAL, OR INCIDENTAL DAMAGE RESULTING FROM, ARISING OUT OF OR IN CONNECTION WITH THE USE OF THE INFORMATION.

