

# Telegärtner 2.2-5 Male Connector for RG-402 Cable, Screw Type, solder/solder, G10 (UT-141)

SKU: ACC-TG-00051

MPN: 100025457

## Description

Introducing the Telegärtner 2.2-5 Male Connector, designed for seamless integration with RG-402 cables.

Engineered with precision, this connector features a screw-type design for secure and reliable connections. Whether for industrial or commercial applications, its versatility makes it ideal for various setups. Crafted for efficiency, it offers solder/solder capabilities, ensuring a robust and enduring connection.

Compatible with G10 (UT-141) cables, it guarantees optimal performance in diverse environments. Trust Telegärtner for unparalleled quality and connectivity solutions.

[Read More](#)



## Telegärtner

As family-owned company the Telegärtner Group has developed to an international network of affiliated companies specialising in intermediate and end products for telecommunications and data communications for customers with the most exacting demands for high-tech applications over the last 70 years.

Since the company was set up in 1945 Telegärtner has seen steady growth and has continually expanded ...

# RF Connector Interface

<b>RF Interface</b>	<b>Body Shape</b>	<b>Mounting</b>
2.2-5 Male	Straight	Free Hanging

## RF Specification

Start Frequency:	0 GHz	Input Impedance:	50
Stop Frequency:	6 GHz	Inner Contact Resistance:	≤ 2 mΩ
PIM, 3rd Order:	≤ -160 dBc	Insulation Resistance:	≥ 1000 mΩ
		Outer Contact Resistance:	≤ 1 mΩ
		RF Operating Voltage:	≤ 1000 Vrms

### VSWR Measurement

Frequency	Return Loss
1000 MHz	≤ -36 dB
4000 MHz	≤ -30 dB
6000 MHz	≤ -25 dB

## Physical Specification

Cable Group:	RG-402	Conductor Attachment:	Cable, Solder
Body Material:	Lead-Brass Alloy (CuZn39Pb3)	Contact Material:	Lead-Brass Alloy (CuZn39Pb3)
Body Plating:	Copper-Silver Alloy (Cu2Ag5 / Cu2Ag3)	Contact Plating:	Copper-Silver Alloy (Cu2Ag5 / Cu2Ag3)
Insulator Material:	PTFE / Teflon	Min. Operating Temperature:	-55 °C
Dimensions:	19 × 17.5 × 17.5	Max. Operating Temperature:	90 °C
Compliance/Certifications:	ISO 9001 Quality Management	Ingress Protection:	IP68
RoHS		Mating Cycles:	> 100

# Drawing

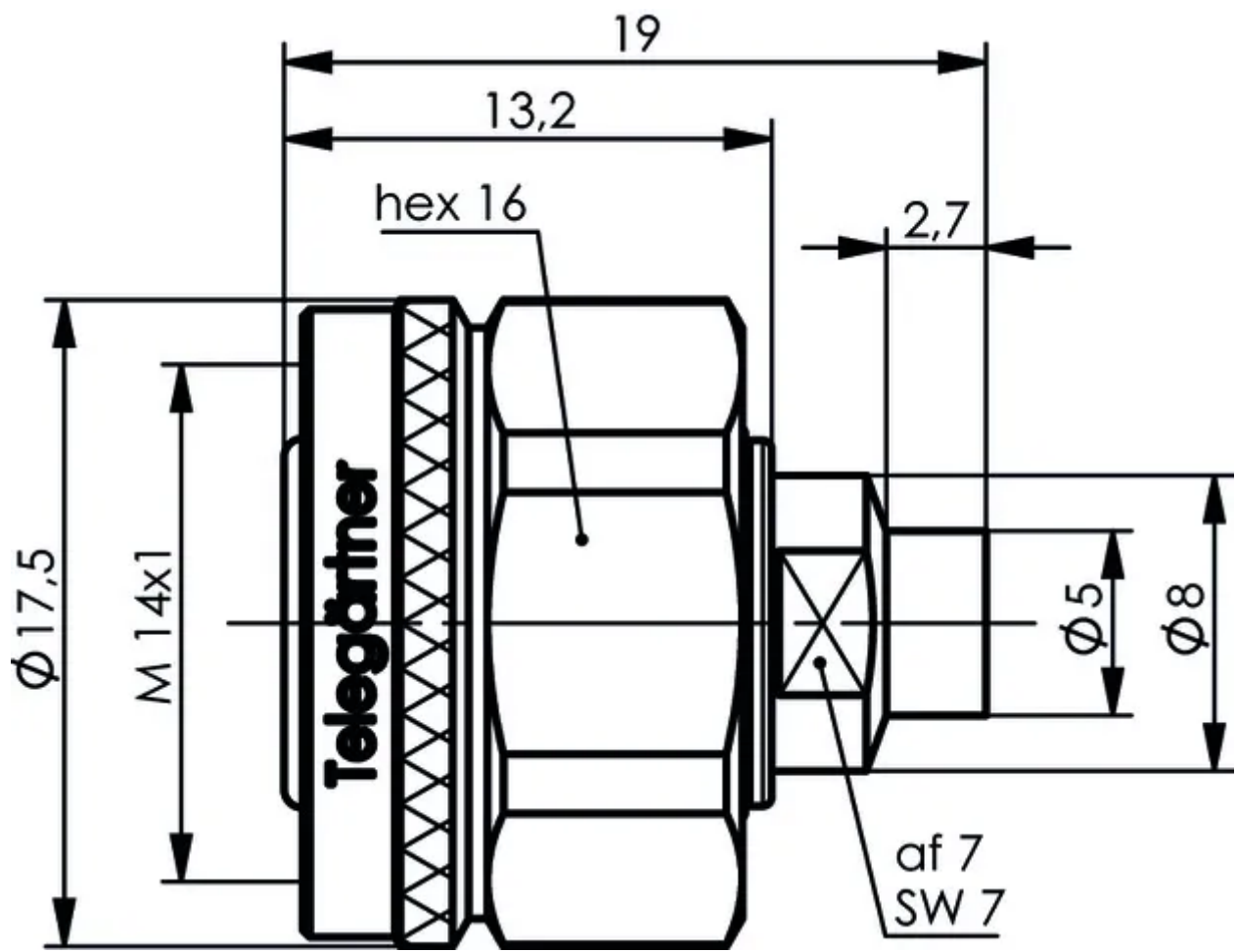

Disclaimer: Although care has been taken to ensure the accuracy, completeness and reliability of the information provided, Powertec assumes no responsibility therefore. The user of the information agrees that the information is subject to change without notice. Powertec assumes no responsibility for the consequences of use of such information, nor for any infringement of third party intellectual property rights which may result from its use. IN NO EVENT SHALL POWERTEC BE LIABLE FOR ANY DIRECT, INDIRECT, SPECIAL, OR INCIDENTAL DAMAGE RESULTING FROM, ARISING OUT OF OR IN CONNECTION WITH THE USE OF THE INFORMATION.

