

Page



Powertec Wireless Technology
ABN: 42 082 948 463
PO Box 1034, Ashmore City
Queensland, Australia, 4214
sales@powertec.com.au
1300 769 378

Powertec 4G-5G Outdoor Wall Mount Antenna, 698 to 4000 MHz, 4.3-10 Female

SKU
ANT-BH-00089
MPN
VPA-6940-7.432
Barcode
9337692004308

Description

The Powertec VPA-6940-7.432 antenna is a versatile panel antenna designed for outdoor applications, supporting a wide frequency range from 698 MHz to 4000 MHz. This antenna is ideal for enhancing wireless communication systems, providing stable connectivity across multiple bands, which makes it suitable for telecommunications, broadcasting, and data transmission applications. Its vertical polarisation and robust gain performance, ranging from 5.5 dBi to 8.0 dBi, ensure efficient signal propagation and reception, even in challenging environments.

Constructed from durable materials such as aluminium and ABS plastic, the antenna is designed to withstand harsh weather conditions, operating effectively between -40 °C and 65 °C. Its compact dimensions (180x158x60 mm) and lightweight design (0.4 kg) make it easy to install, either on poles with diameters between 30 mm and 52 mm or other mounting structures. The antenna's low passive...

[Read More](#)





Powertec

Powertec is a wireless technology manufacturer and systems integrator based in Australia. Operating since 1995, Powertec has grown to become the leading wireless technology distributor in its region, and a leading Infratech systems developer. Supporting over 1500 partners the company provides procurement, design, project management, and support services across Australia, New Zealand, Pacific ...

RF Specification

Start Frequency

698 MHz

Stop Frequency

4000 MHz

Max. Input Power

50 W

Polarisation

[Vertical \(V\)](#)

Input Impedance

50 Ω

RF Connectors

Ports RF Interface Body Shape Cable Series Length

1	<u>4.3-10 Female</u>	<u>Straight</u>	<u>PSF-402</u>	300 mm
---	--------------------------------------	---------------------------------	--------------------------------	--------

Frequency Test Data

Start Freq. Stop Freq. Peak Gain VSWR Azimuth Elevation F/B Ratio

698 MHz	806 MHz	5.5 dBi	< 2:1	100°	90°	> 9 dB
806 MHz	960 MHz	6.5 dBi	< 2:1	85°	82°	> 10 dB
1710 MHz	2700 MHz	8 dBi	< 1.8:1	65°	60°	> 15 dB

Start Freq. Stop Freq. Peak Gain VSWR Azimuth Elevation F/B Ratio

3300 MHz 4000 MHz 7 dBi < 1.8:1 50° 45° > 11 dB

Physical Specification

Subtype

[Panel / Sector](#)

Input Ports

1

MIMO

[1x1 SISO](#)

Min. Operating Temperature

-40 °C

Max. Operating Temperature

65 °C

PIM, 3rd Order

-150 dBc

Dimensions

180x158x60

Materials

[ABS Plastic](#), [Aluminium](#)

Mounting

[Pole Clamp 30 to 52 mm ø](#), [Wall / Vertical Surface](#)

Weight

0.4 kg

Drawing

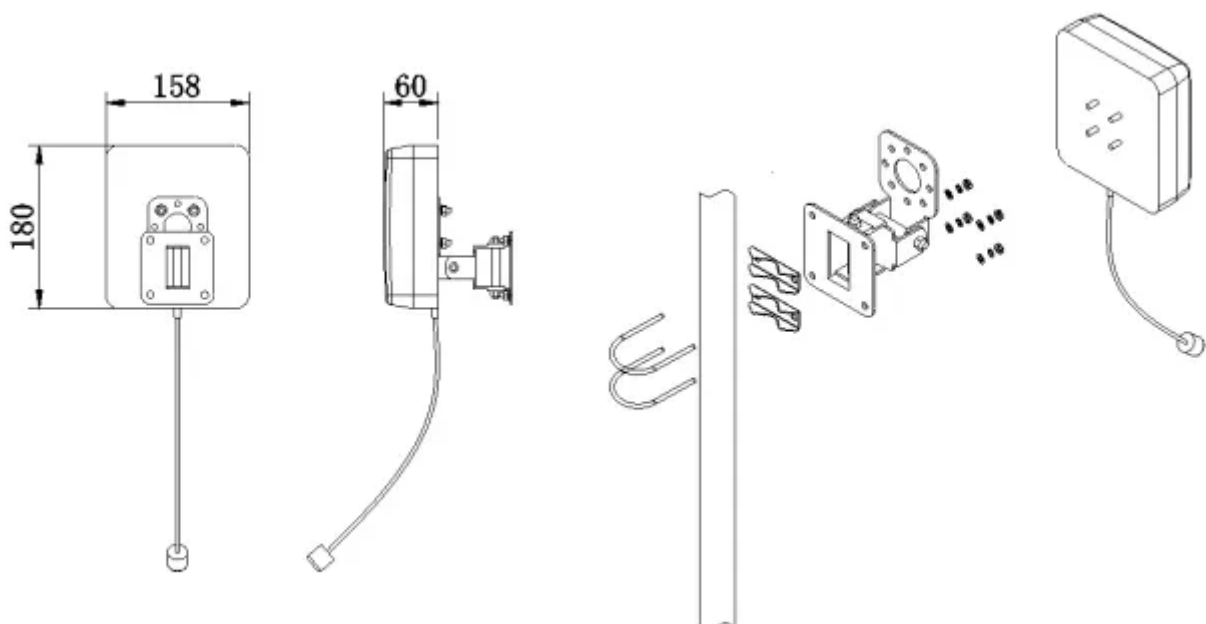

Disclaimer: Although care has been taken to ensure the accuracy, completeness and reliability of the information provided, Powertec assumes no responsibility therefore. The user of the information agrees that the information is subject to change without notice. Powertec assumes no responsibility for the consequences of use of such information, nor for any infringement of third party intellectual property rights which may result from its use. IN NO EVENT SHALL POWERTEC BE LIABLE FOR ANY DIRECT, INDIRECT, SPECIAL, OR INCIDENTAL DAMAGE RESULTING FROM, ARISING OUT OF OR IN CONNECTION WITH THE USE OF THE INFORMATION.

