

Page



Powertec Wireless Technology
ABN: 42 082 948 463
PO Box 1034, Ashmore City
Queensland, Australia, 4214
sales@powertec.com.au
1300 769 378

Powertec 2x2 Hybrid Combiner, 700-3800MHz, N Female, -155dBc

SKU
IBC-PT-00108
MPN
PCM-HY2-6938.N2
Barcode
9337692005329

Description

The Powertec 2x2 Hybrid Combiner (SKU: IBC-PT-00108, Part Number: PCM-HY2-6938.N2) is an advanced RF passive component designed for optimal performance across a frequency range of 698 MHz to 3800 MHz. With a coupling/division value of 3 dB, it ensures efficient signal distribution. This device features N Female connectors for both input and output ports, facilitating easy integration into existing systems.

Certified with an IP65 rating, it is robust and suitable for outdoor applications, capable of operating in temperatures from -25 °C to 75 °C. The Hybrid Combiner boasts a 3rd Order PIM rating of -155 dBc, maintaining high signal integrity. Its electrical performance includes a VSWR of less than 1.3:1, an insertion loss of 1.00 dB, and inter-port isolation greater than 22 dB, making it ideal for demanding wireless infrastructure setups.

Compliant with RoHS standards, this component meets modern environmental regulations. Its compact...

[Read More](#)





Powertec

Powertec is a wireless technology manufacturer and systems integrator based in Australia. Operating since 1995, Powertec has grown to become the leading wireless technology distributor in its region, and a leading Infratech systems developer. Supporting over 1500 partners the company provides procurement, design, project management, and support services across Australia, New Zealand, Pacific ...

RF Specification

Min. Frequency

698 MHz

Max. Frequency

3800 MHz

Coupling / Split

3 dB

Input Impedance

50 Ω

Max. Input Power

200 W

PIM, 3rd Order

-155 dBc

Port Matrix

Port Label Port Function RF Interface

IN	Input	N Female
----	-------	--------------------------

OUT	Output	N Female
-----	--------	--------------------------

Frequency Test Data

Start Frequency Stop Frequency VSWR Insertion Loss Inter-Port Iso.

698 MHz

3800 MHz

< 1.3:1 1 dB

> 22 dB

Physical Specification

Input Ports

2

Output Ports

2

Subtype

[Hybrid Coupler](#)

Ingress Protection

[IP65](#)

Dimensions

146.5 x 84.4 x 36

Weight

0.56 kg

Min. Operating Temperature

-25 °C

Max. Operating Temperature

75 °C

Compliance/Certifications

[RoHS](#)

Drawing

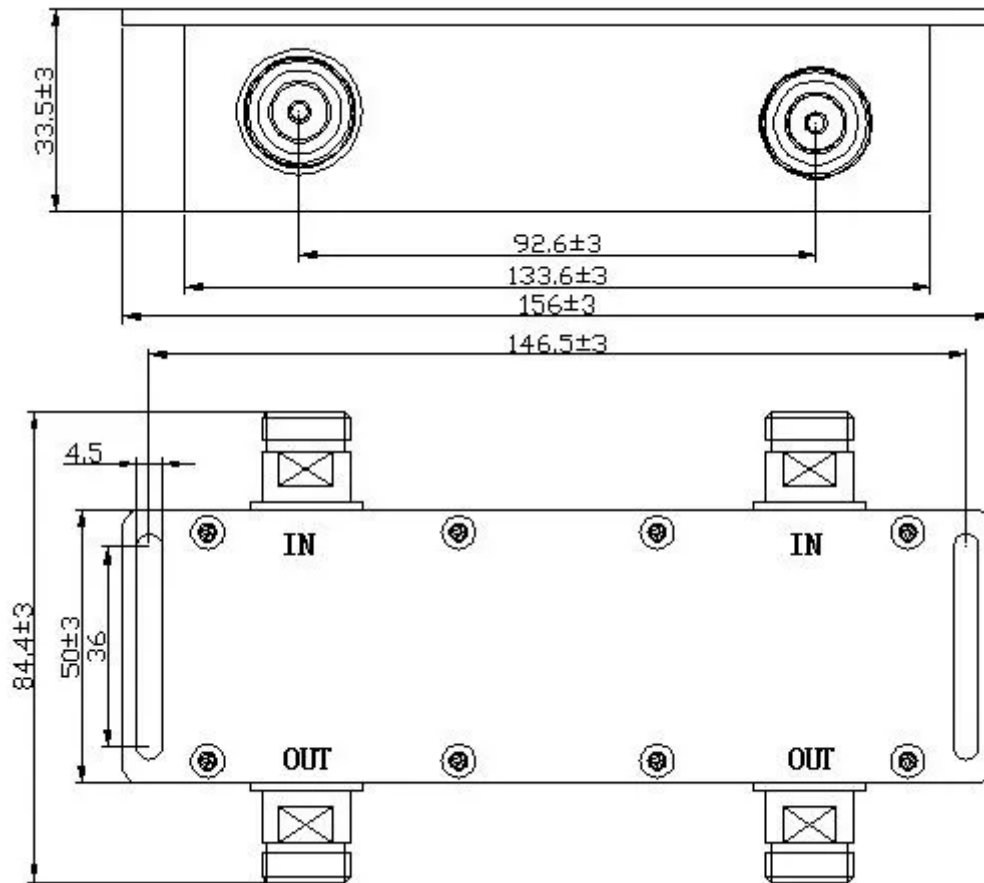

Disclaimer: Although care has been taken to ensure the accuracy, completeness and reliability of the information provided, Powertec assumes no responsibility therefore. The user of the information agrees that the information is subject to change without notice. Powertec assumes no responsibility for the consequences of use of such information, nor for any infringement of third party intellectual property rights which may result from its use. IN NO EVENT SHALL POWERTEC BE LIABLE FOR ANY DIRECT, INDIRECT, SPECIAL, OR INCIDENTAL DAMAGE RESULTING FROM, ARISING OUT OF OR IN CONNECTION WITH THE USE OF THE INFORMATION.

