

4.3-10 Male Connector for L-400 Coaxial Cable

SKU: IBC-PT-00019

MPN: 431-C-L40

Barcode: 9337692002342

Description

4.3-10 RF connectors are designed to meet the demands of 4G and 5G technologies, supporting very high order modulation schemes like 256QAM, wide aggregated bandwidths, and extended operating bands up to 6 GHz.

This crimp-style 4.3-10 Male connector terminates L-400 series cables, such as LMR-400 and PTL-400. In addition to 4G and 5G antenna types, 4.3-10 connectors are becoming popular on a range of high performance wireless systems.

This model of 4.3-10 connector is weatherproof when mated with an IP65 female connector.

[Read More](#)

The 4.3-10 Male Connector for L-400 Coaxial Cable is an advanced RF connector specifically engineered for modern wireless communication systems, including 4G and 5G networks. This connector is integral in supporting high-order modulation schemes like 256QAM and accommodates wide aggregated bandwidths, operating efficiently across extended frequency bands up to 6 GHz. Designed to terminate L-400 series cables, such as LMR-400 and PTL-400, it ensures reliable connectivity for high-performance wireless systems.

Its robust construction features a brass body with white bronze plating and silver-plated inner contacts, providing excellent conductivity and durability. The PTFE/Teflon insulator further enhances its electrical performance. Notably, the connector is



Powertec

Powertec is a wireless technology manufacturer and systems integrator based in Australia. Operating since 1995, Powertec has grown to become the leading wireless technology distributor in its region, and a leading Infratech systems developer. Supporting over 1500 partners the company provides procurement, design, project management, and support services across Australia, New Zealand, Pacific ...

RF Connector Interface

RF Interface	Body Shape	Mounting
4.3-10 Male	Straight	Free Hanging

RF Specification

Start Frequency:	0 GHz	Input Impedance:	50
Stop Frequency:	6 GHz	Inner Contact Resistance:	≤ 1.5 mΩ
		Insulation Resistance:	≥ 5000 mΩ
		Outer Contact Resistance:	≤ 0.4 mΩ
		RF Operating Voltage:	≤ 1000 Vrms

VSWR Measurement

Frequency	VSWR	Insertion Loss
6000 MHz	≤ 1.2:1	0.1 dB

Physical Specification

Cable Group:	L-400	Conductor Attachment:	Cable, Crimp
Body Material:	Brass	Contact Material:	Brass
Body Plating:	White Bronze	Contact Plating:	Silver
Insulator Material:	PTFE / Teflon	Min. Operating Temperature:	-40 °C
Dimensions:	29.7 × 34 × 34	Max. Operating Temperature:	85 °C
Weight:	80 g	Ingress Protection:	IP67
Compliance/Certifications:	ISO 9001 Quality Management	Mating Cycles:	> 500

RoHS

Drawing

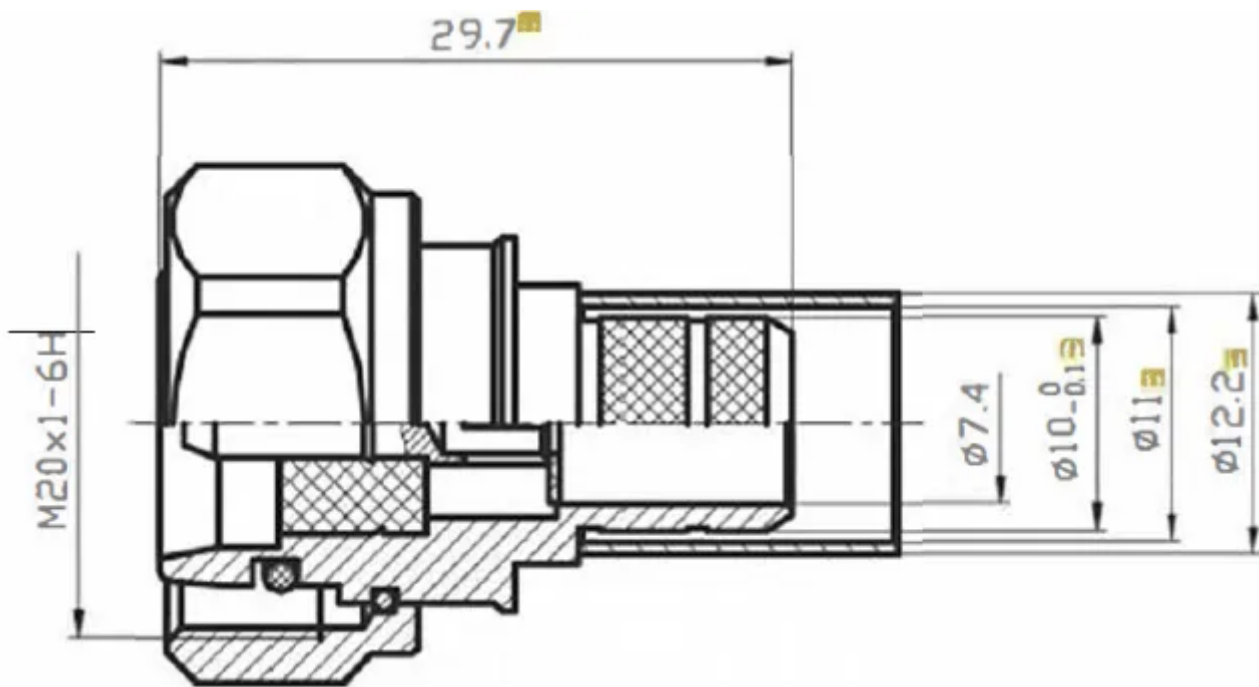

Disclaimer: Although care has been taken to ensure the accuracy, completeness and reliability of the information provided, Powertec assumes no responsibility therefore. The user of the information agrees that the information is subject to change without notice. Powertec assumes no responsibility for the consequences of use of such information, nor for any infringement of third party intellectual property rights which may result from its use. IN NO EVENT SHALL POWERTEC BE LIABLE FOR ANY DIRECT, INDIRECT, SPECIAL, OR INCIDENTAL DAMAGE RESULTING FROM, ARISING OUT OF OR IN CONNECTION WITH THE USE OF THE INFORMATION.

