

RF Adapter SMA Female to SMA Male Right Angle

SKU: ACC-PT-00190

MPN: AD-SA2SA1-RA

Barcode: 9337692003523

Description

The RF Adapter SMA Female to SMA Male Right Angle (AD-SA2SA1-RA) by Powertec is a 50 Ω coaxial adapter designed for high-frequency applications. It features right-angle SMA Female and SMA Male interfaces, both with a free-hanging mounting mechanism, ensuring compatibility and ease of installation.

This adapter supports an operating frequency range from 0 GHz to 6 GHz. Constructed from brass with a gold finish, it ensures durability and reliable signal transmission. The inner contacts are made of phosphor bronze with gold plating, providing excellent conductivity and resistance to corrosion.

It operates efficiently in extreme temperatures ranging from -65 °C to 165 °C. The adapter adheres to ISO 9001 Quality Management standards and is RoHS compliant, emphasising its quality and environmental responsibility.

Ideal for use in wireless communication systems and cellular network enhancement, this adapter meets the high standards expected in...

[Read More](#)



Powertec

Powertec is a wireless technology manufacturer and systems integrator based in Australia. Operating since 1995, Powertec has grown to become the leading wireless technology distributor in its region, and a leading Infratech systems developer. Supporting over 1500 partners the company provides procurement, design, project management, and support services across Australia, New Zealand, Pacific ...

RF Connector Interface

RF Interface	Body Shape	Mounting
SMA Female	Right Angle	Free Hanging
SMA Male	Right Angle	Free Hanging

RF Specification

Start Frequency:	0 GHz	Input Impedance:	50
Stop Frequency:	6 GHz	Inner Contact Resistance:	≤ 1 mΩ
RF Operating Voltage:	≥ 500 Vrms	Insulation Resistance:	≥ 5000 mΩ
		Outer Contact Resistance:	≤ 1 mΩ

VSWR Measurement

Frequency	VSWR
6000 MHz	≤ 1.5:1

Physical Specification

Body Material:	Brass	Contact Material:	Phosphor Bronze
Body Plating:	Gold	Contact Plating:	Gold
Insulator Material:	PTFE / Teflon	Min. Operating Temperature:	-65 °C
Dimensions:	16.6 x 14.5 x 8 mm	Max. Operating Temperature:	165 °C
Weight:	8.4 g	Mating Cycles:	> 500
Compliance/Certifications:	ISO 9001 Quality Management		
RoHS			

Drawing

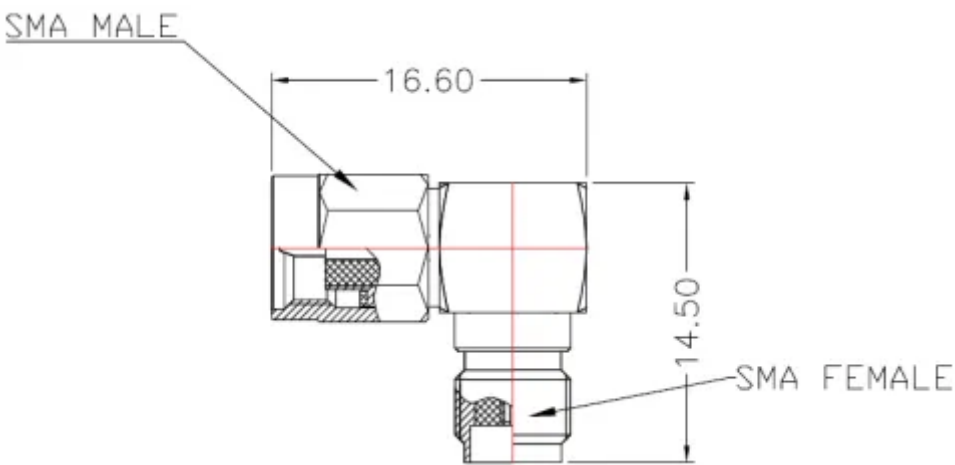

Disclaimer: Although care has been taken to ensure the accuracy, completeness and reliability of the information provided, Powertec assumes no responsibility therefore. The user of the information agrees that the information is subject to change without notice. Powertec assumes no responsibility for the consequences of use of such information, nor for any infringement of third party intellectual property rights which may result from its use. IN NO EVENT SHALL POWERTEC BE LIABLE FOR ANY DIRECT, INDIRECT, SPECIAL, OR INCIDENTAL DAMAGE RESULTING FROM, ARISING OUT OF OR IN CONNECTION WITH THE USE OF THE INFORMATION.

