

Page



Powertec Wireless Technology  
ABN: 42 082 948 463  
PO Box 1034, Ashmore City  
Queensland, Australia, 4214  
sales@powertec.com.au  
1300 769 378

## **RF Adapter SMA Female to SMA Female, Bulkhead Rear Mount**

SKU  
ACC-PT-00163  
MPN  
AD-SA2SA2-BRM  
Barcode  
9337692001543

## Description

The RF Adapter SMA Female to SMA Female, Bulkhead Rear Mount (Part Number: AD-SA2SA2-BRM) by Powertec is a high-quality 50  $\Omega$  coaxial adapter designed for seamless RF connections. Featuring dual SMA Female interfaces with straight body shapes, this adapter supports mounting mechanisms for both bulkhead front and rear. It ensures compatibility with SMA Male interfaces.

Operating within a frequency range of 0 GHz to 6 GHz, this adapter is built from durable Brass with a Gold finish, and includes brass inner contacts with gold plating for reliable performance. It functions efficiently in temperatures ranging from -55 °C to 155 °C. Compliant with ISO 9001 Quality Management and RoHS standards, this product guarantees exceptional quality.

Powertec, an Australian wireless technology manufacturer and systems integrator, has been a leader since 1995. Known for enhancing cellular networks and developing wireless and renewable energy systems...

[Read More](#)





## **Powertec**

Powertec is a wireless technology manufacturer and systems integrator based in Australia. Operating since 1995, Powertec has grown to become the leading wireless technology distributor in its region, and a leading Infratech systems developer. Supporting over 1500 partners the company provides procurement, design, project management, and support services across Australia, New Zealand, Pacific ...

## **RF Connector Interface**

### **RF Interface Body Shape Mounting**

[SMA Female](#)   [Straight](#)   [Bulkhead](#)

[SMA Female](#)   [Straight](#)   [Bulkhead](#)

## **RF Specification**

Start Frequency

0 GHz

Stop Frequency

6 GHz

RF Operating Voltage

$\geq 500$  Vrms

Input Impedance

50  $\Omega$

Inner Contact Resistance

$\leq 1$  m $\Omega$

Insulation Resistance

$\geq 5000$  m $\Omega$

Outer Contact Resistance

$\leq 1 \text{ m}\Omega$

VSWR Measurement

**Frequency VSWR**

6000 MHz  $\leq 1.3:1$

## Physical Specification

Body Material

[Brass](#)

Body Plating

[Gold](#)

Insulator Material

[PTFE / Teflon](#)

Dimensions

22.1 x 11 mm (L x Dia)

Weight

5.8 g

Compliance/Certifications

[ISO 9001 Quality Management](#)

,

[RoHS](#)

Contact Material

[Brass](#)

Contact Plating

[Gold](#)

Min. Operating Temperature

-55 °C

Max. Operating Temperature

155 °C

Mating Cycles

> 500

Drawing

Image

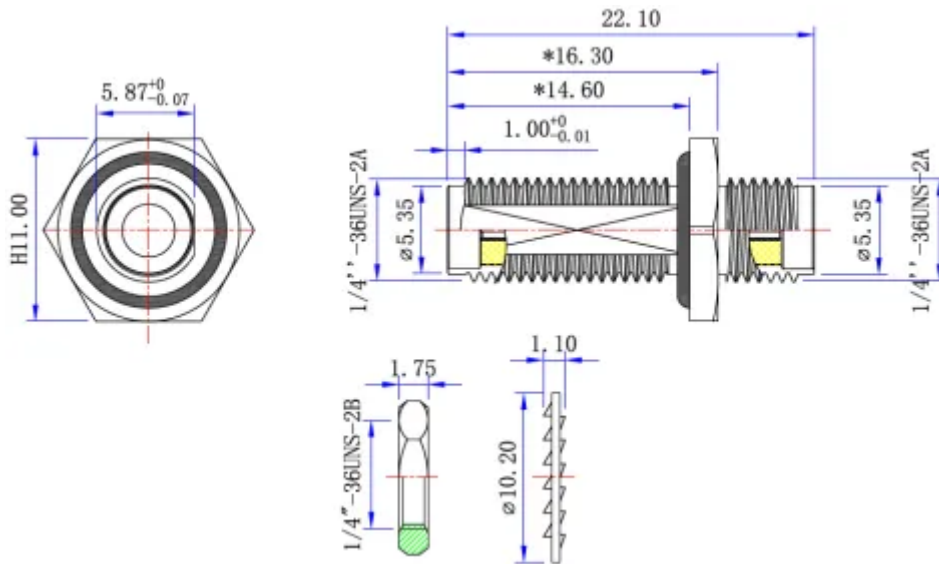

Disclaimer: Although care has been taken to ensure the accuracy, completeness and reliability of the information provided, Powertec assumes no responsibility therefore. The user of the information agrees that the information is subject to change without notice. Powertec assumes no responsibility for the consequences of use of such information, nor for any infringement of third party intellectual property rights which may result from its use. IN NO EVENT SHALL POWERTEC BE LIABLE FOR ANY DIRECT, INDIRECT, SPECIAL, OR INCIDENTAL DAMAGE RESULTING FROM, ARISING OUT OF OR IN CONNECTION WITH THE USE OF THE INFORMATION.

