

Page



Powertec Wireless Technology  
ABN: 42 082 948 463  
PO Box 1034, Ashmore City  
Queensland, Australia, 4214  
sales@powertec.com.au  
1300 769 378

## **Telegartner 4.3-10 angle plug, Screw Type, clamp/clamp, G23 (1/2" Flex), SIMFix Pro**

SKU  
ACC-TG-00011  
MPN  
100025190

## Description

The Telegärtner 4.3-10 angle plug is a high-performance coaxial RF connector designed for telecommunications and data communication applications. Engineered for reliability in demanding environments, this connector is ideal for use with 1/2" corrugated cables in mobile networks, broadcast systems, and industrial settings. Its right-angle design facilitates easy installation in tight spaces, while the screw-type, clamp/clamp mechanism ensures secure cable attachment.

Constructed with a robust brass body plated with a copper-silver alloy, the connector offers excellent conductivity and durability. The beryllium copper inner contacts, also copper-silver plated, enhance signal integrity. With a PTFE insulator, it operates efficiently across a wide temperature range from -40 °C to 85 °C, making it suitable for both indoor and outdoor applications.

This connector supports frequencies up to 6 GHz, ensuring high-performance transmission with...

[Read More](#)



## Telegärtner

As family-owned company the Telegärtner Group has developed to an international network of affiliated companies specialising in intermediate and end products for telecommunications and data communications for customers with the most exacting demands for high-tech applications over the last 70 years.

Since the company was set up in 1945 Telegärtner has seen steady growth and has continually expanded ...

## **RF Connector Interface**

### **RF Interface Body Shape Mounting**

[4.3-10 Male](#) [Right Angle](#) [Free Hanging](#)

## **RF Specification**

Start Frequency

0 GHz

Stop Frequency

6 GHz

Peak Power

2.5 kW

PIM, 3rd Order

$\leq -155$  dBc

Input Impedance

50  $\Omega$

Inner Contact Resistance

$\leq 1$  m $\Omega$

Insulation Resistance

$\geq 5000 \text{ m}\Omega$

Outer Contact Resistance

$\leq 1 \text{ m}\Omega$

RF Operating Voltage

$\leq 1000 \text{ Vrms}$

VSWR Measurement

**Frequency VSWR Return Loss Insertion Loss**

2000 MHz  $\leq 1.2:1 \leq 34 \text{ dB}$  0.15 dB

## Physical Specification

Cable Group

[1/2 Corrugated](#)

Body Material

[Brass](#)

Body Plating

[Copper-Silver Alloy \(Cu<sub>2</sub>Ag<sub>5</sub> / Cu<sub>2</sub>Ag<sub>3</sub>\)](#)

Insulator Material

[PTFE / Teflon](#)

Dimensions

45.5 x 26

Weight

184 g

Compliance/Certifications

[RoHS](#)

Conductor Attachment

[Cable, Captivated](#)

Contact Material

[Beryllium Copper](#)

Contact Plating

[Copper-Silver Alloy \(Cu<sub>2</sub>Ag<sub>5</sub> / Cu<sub>2</sub>Ag<sub>3</sub>\)](#)

Min. Operating Temperature

-40 °C

Max. Operating Temperature

85 °C

Ingress Protection

[IP68](#)

Mating Cycles

> 100

## Drawing

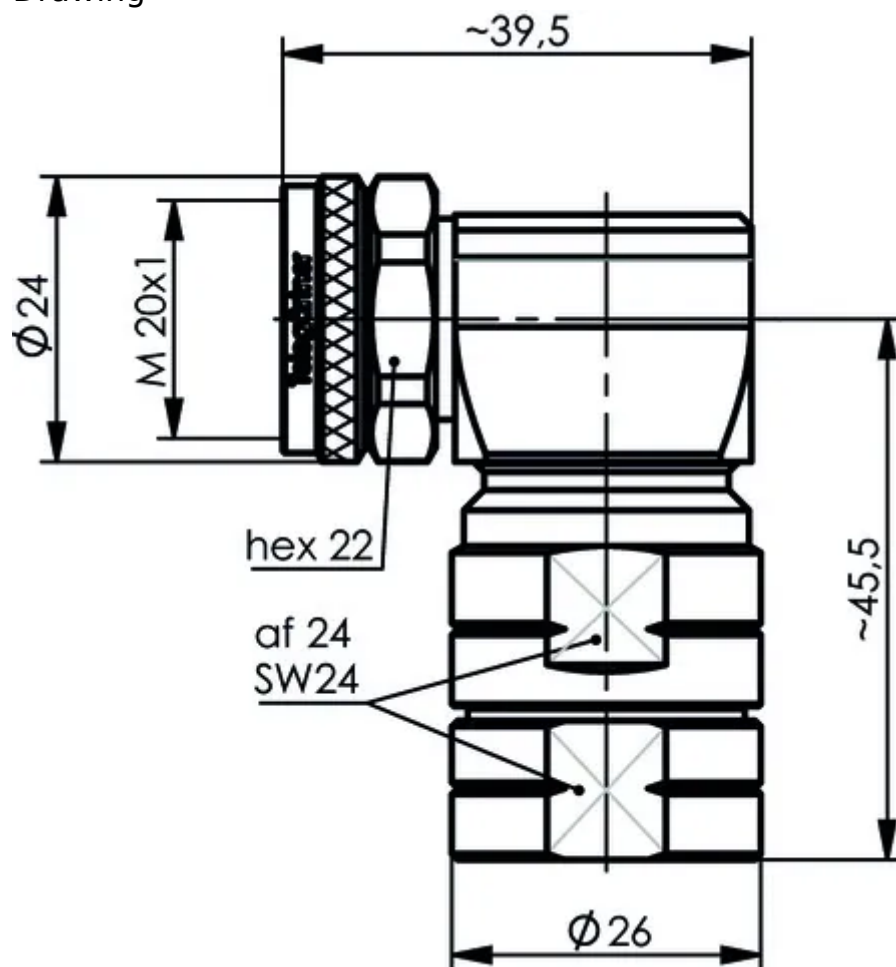

Disclaimer: Although care has been taken to ensure the accuracy, completeness and reliability of the information provided, Powertec assumes no responsibility therefore. The user of the information agrees that the information is subject to change without notice. Powertec assumes no responsibility for the consequences of use of such information, nor for any infringement of third party intellectual property rights which may result from its use. IN NO EVENT SHALL POWERTEC BE LIABLE FOR ANY DIRECT, INDIRECT, SPECIAL, OR INCIDENTAL DAMAGE RESULTING FROM, ARISING OUT OF OR IN CONNECTION WITH THE USE OF THE INFORMATION.

